



Washer extractor

W5105N

Features and benefits

- **Compass Pro® microprocessor offers:**
 - Large display and one control knob for easy program selection
 - Language selection
 - Quick selection and option buttons for the most frequently used wash programs and options
 - Wash program packages optimized on *Economy, Performance and Time*. (Available on general programs)
- Extremely low water and energy consumption – see table below
- Four compartment detergent box for manual dosing of powder or liquid detergent
- High extraction force for efficient dewatering
- Door with gasket and strong hinges built for heavy duty operation
- Stainless and galvanized steel in all vital parts for high degree of rust protection
- SuperBalance guarantees the correct extraction force



Images shown are a representation of the product only and variations may occur.

Main options

- Automatic liquid detergent supply (optional I/O board)
- Stainless steel front panel
- Connection to booking- /payment- system or coin meter
- Drain pump

| Main specifications | | | | W5105N | | | |
|---------------------------------------|--------------------|-------------|----|------------------|-------------------|------------------|-------------------|
| Max. capacity | filling factor 1:9 | kg/lb | | 11/25 | | | |
| Drum, | volume | litre | | 105 | | | |
| | diameter | ø mm | | 595 | | | |
| Extraction | | rpm | | 548 | | | |
| G-factor | | | | 100 | | | |
| Standard heating alternatives | | electricity | kW | 7.5 / 10.0 | | | |
| Low energy heating alternatives | | electricity | kW | 3.0 | | | |
| | | steam | | x | | | |
| | | non-heated | | x | | | |
| Consumption data "Normal 60°C" | | | | EI | | Steam** | |
| Economy* | | | | Full load, 11 kg | Half load, 5.5 kg | Full load, 11 kg | Half load, 5.5 kg |
| Total time | | min | | 45 | 43 | 45 | 43 |
| Water consumption (cold+hot) | | litre | | 61+19 | 49+13 | 61+19 | 49+13 |
| Energy consumption (motor/heating***) | | kWh | | 0.15/1.75 | 0.1/1.2 | 0.15/- | 0.1/- |
| Steam consumption | | kg | | - | - | 2.6 | 1.8 |
| Residual moisture | | % | | 69 | 78 | 69 | 78 |

* Water temperature 15°C cold water and 65°C hot water.

** Depending on steam pressure.

*** Includes hot water heating.



Electrical connections

| Heating alternative | Main voltage | | Heating power kW | Total power kW | Recommended fuse A |
|---------------------|----------------|-------|------------------|----------------|--------------------|
| | Hz | Hz | | | |
| Electric heated | 220-240V 1 ~ | 50/60 | 3.0/7.5/10.0 | 3.3/7.8/10.3 | 20/35/50 |
| | 220-240V 3 ~ | 50/60 | 7.5/10.0 | 7.8/10.3 | 25/35 |
| | 380-415V 3N ~ | 50/60 | 7.5/10.0 | 7.8/10.3 | 16/20 |
| | 440V 3 ~ | 60 | 7.5/10.0 | 7.8/10.3 | 16 |
| | 480V 3 ~ | 60 | 7.5/10.0 | 7.8/10.3 | 16 |
| Steam or Non heated | 220-480V 1/3 ~ | 50/60 | - | 0.8 | 10 |

| Water and steam connection | | W5105N | |
|-----------------------------------|-----------------------|-----------|-------------------------|
| Water valves | DN | 20 | |
| Water pressure | kPa | 200-600 | |
| Capacity at 300 kPa | l/min | 20 | |
| Drain valve | ø mm | 75 | |
| Draining capacity | l/min | 170 | |
| Steam valve | DN | 15 | |
| Steam pressure | kPa | 300-600 | |
| Liquid detergent supplies | | 5 | |
| Floor requirements | | | |
| Frequency of the dynamic force | Hz | 9.1 | |
| Floor load at max extraction | kN | 1.9 ± 2.5 | |
| Sound levels | | | |
| Sound power level (IEC 60704-2-4) | | | |
| wash | dB(A) | 64 | |
| extraction | dB(A) | 70 | |
| Heat emission | | | |
| % of installed power, max | | 5 | |
| Shipping data | | | |
| Weight | net, kg | 145 | |
| | crated, kg | 167 | |
| Shipping volume | m ³ | 0.9 | |
| Accessories | | | |
| Steel base | | x | |
| Hose kits for water or steam | | x | |
| Fluff collector | | x | |
| Dimensions in mm | | | |
| A | Width | 720 | |
| B | Depth | 705 | |
| C | Height | 1200 | |
| D | | 365 | |
| E | | 740 | |
| F | | 910 | |
| G | | 45 | |
| H | | 1115 | |
| I | | 215 | |
| J | | 130 | |
| K | | 1095 | |
| L | | 910 | |
| M | | 420 | |
| N | | 100 | |
| O | | 235 | |
| 1 | Operating panel | 6 | Water re-use |
| 2 | Door opening ø 365 mm | 7 | Drain |
| 3 | Detergent box | 8 | Liquid detergent supply |
| 4 | Cold water | 9 | Electrical connection |
| 5 | Hot water | 10 | Steam connection |

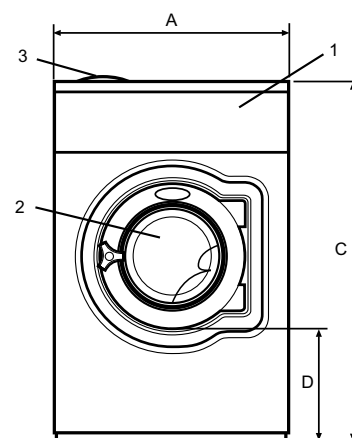

Front

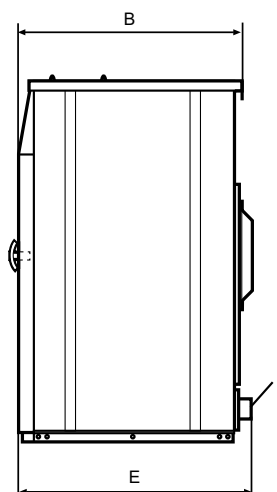

Side view

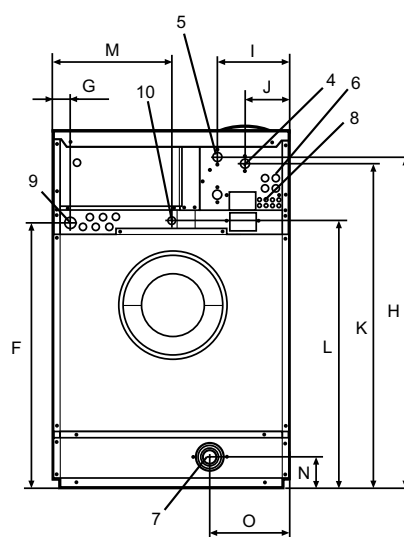

Rear

Front and side panels in light grey and blue (RAL 260 70 05, 250 60 30)

* Other voltages available, see installation manual